

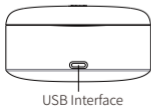

# Product Introduction

## Appearance and Components

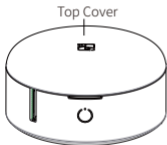
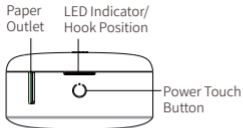

## Packing List



Printer



USB Cable



Quick Start Guide

EN

# Product Introduction

## LED Indicator Status

- Red LED    Error Status
  - ON: Error (Paper jam/Paper end/Cover opened)
  - Quick Flash: TPH is over temperature
  - Slow Flash: Low power
  
- White LED    Basic Status
  - ON: Charging finished/Printer is ready
  - Slow Flash: Charging

## Touch Button Operation

- 1 Hold down the power touch button for a few seconds: Turn on/off the printer
- 2 Double click the power touch button: Position and calibrate the location of thermal label paper and heating line

## Paper Loading

- 1 Open the top cover by the hook position as the direction shown in the figure.

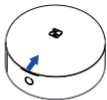

- 2 Load the paper as shown on the right.

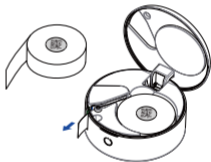

- 3 Close the cover and pull some extra paper.

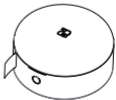

## App Download

Scan the QR code to download App.



## Connection and Printing

### 01

Turn on Bluetooth of mobile phone, then open App, select “H11” in the device list. Click “Search device” and find “H11-XXXX”, click it to connect.



### 02

Select “Scan to get template”, scan the QR code on the roll core to get the template.



### 03

Edit the label as need, and then click “Print” after editing.



Note: App operation shall be subject to the latest version.

## Battery Charging

When the battery power is low, the red LED indicator will flash slowly. Please charge it by the exclusive USB cable in time. If you continue printing, it may power off automatically.

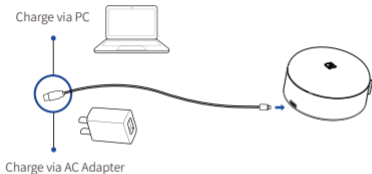

Note: The printer can be charged via computer USB port or AC adapter. Please note that the AC adapter is not supplied.

## FCC WARNING

This device complies with part 15 of the FCC Rules. Operation is subject to the following two conditions: (1) this device may not cause harmful interference, and (2) this device must accept any interference received, including interference that may cause undesired operation.

Any changes or modifications not expressly approved by the party responsible for compliance could void the user's authority to operate the equipment.

NOTE: This equipment has been tested and found to comply with the limits for a Class B digital device, pursuant to Part 15 of the FCC Rules. These limits are designed to provide reasonable protection against harmful interference in a residential installation. This equipment generates, uses and can radiate radio frequency energy and, if not installed and used in accordance with the instructions, may cause harmful interference to radio communications. However, there is no guarantee that interference will not occur in a particular installation.

If this equipment does cause harmful interference to radio or television reception, which can be determined by turning the equipment off and on, the user is encouraged to try to correct the interference by one or more of the following measures:

- Reorient or relocate the receiving antenna.
- Increase the separation between the equipment and receiver.
- Connect the equipment into an outlet on a circuit different from that to which the receiver is connected.
- Consult the dealer or an experienced radio/TV technician for help.



 Note: All the drawings of product and accessories in the manual are for reference only, please subject to the actual product.





**Xiamen Hanin Electronic Technology Co., Ltd.**

E-mail: [support@hpert.com](mailto:support@hpert.com)

Web: [www.hpert.com](http://www.hpert.com)